

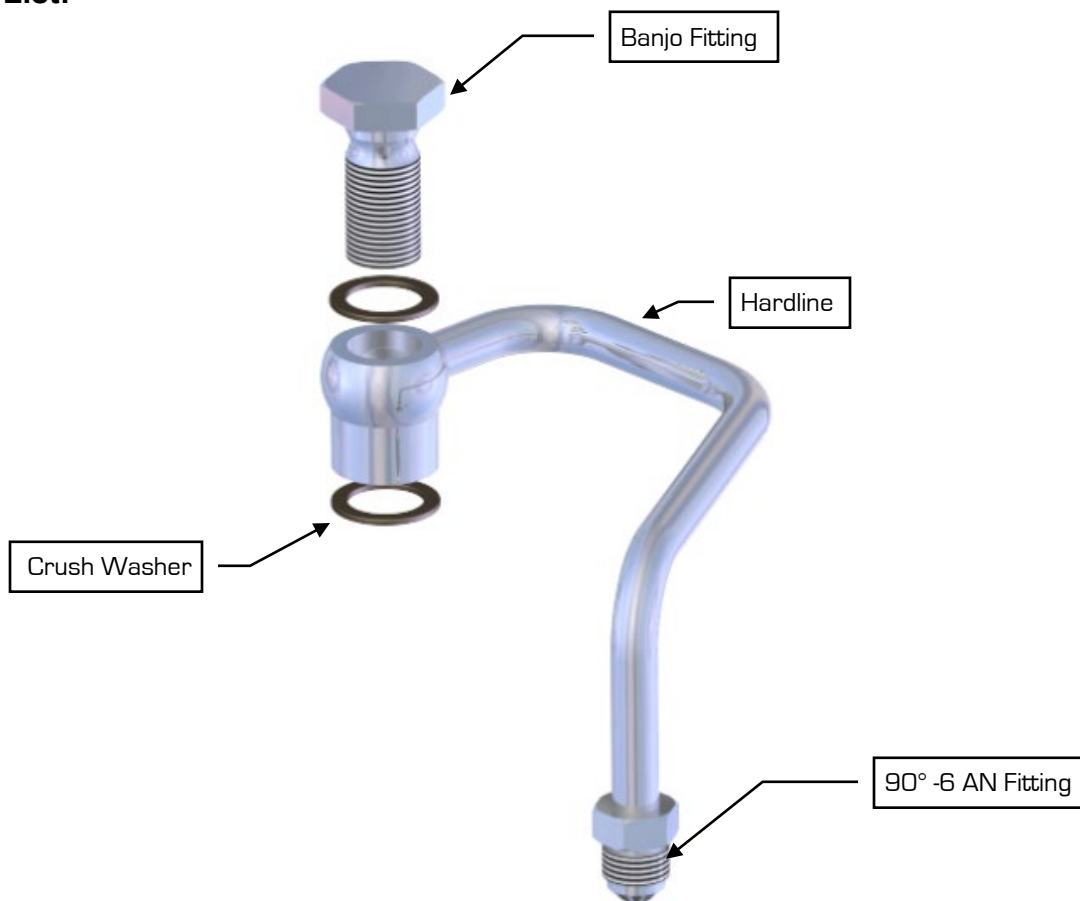

**Installation Instructions**  
**DSE -6 AN "Hardline Pressure Tube" with Banjo Bolt Connector**  
**091702**

Detroit Speed and Engineering's "Hardline Pressure Tube" is specifically designed to route neatly around the DSE power steering pump with integral reservoir. It features a banjo fitting attachment to the pressure port of the pump and hard tubing that routes around the reservoir with a -6 AN fitting,

**Parts List:**



**Supplementary Part:**

A 90° -6 AN fitting with a compression attachment for the power steering hose can be used to connect the Hardline to the braided power steering hose.

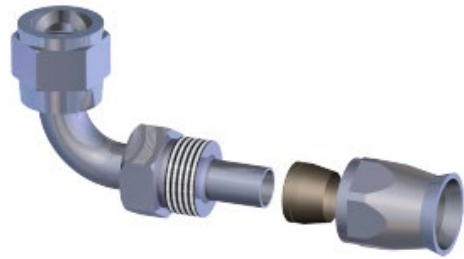

### Installation Instructions:

1. Screw the Banjo fitting into the pressure port of the pump (refer to figure below)
2. Position the Hardline to route behind the reservoir
3. Torque the banjo fitting to 25-30 ft/lbs

